

MSBA SCHEMATIC DESIGN SUBMISSION

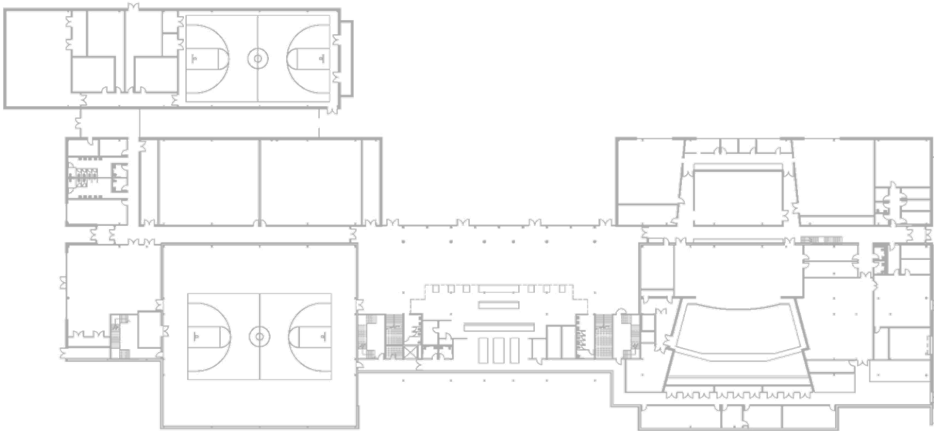

SPED Program 1st Floor

None

JANUARY 2012 DESE APPROVED SUBMISSION

* The PFA was amended with the DESE approved submission

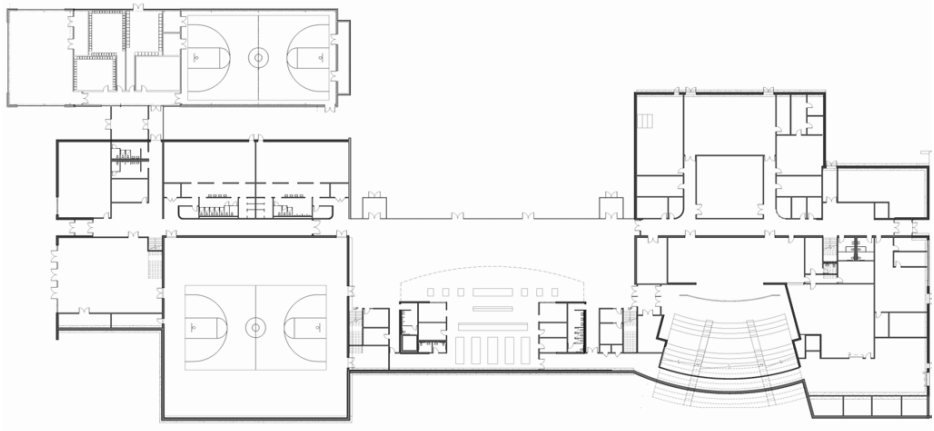

SPED Program 1st Floor

None

JUNE DD ESTIMATE

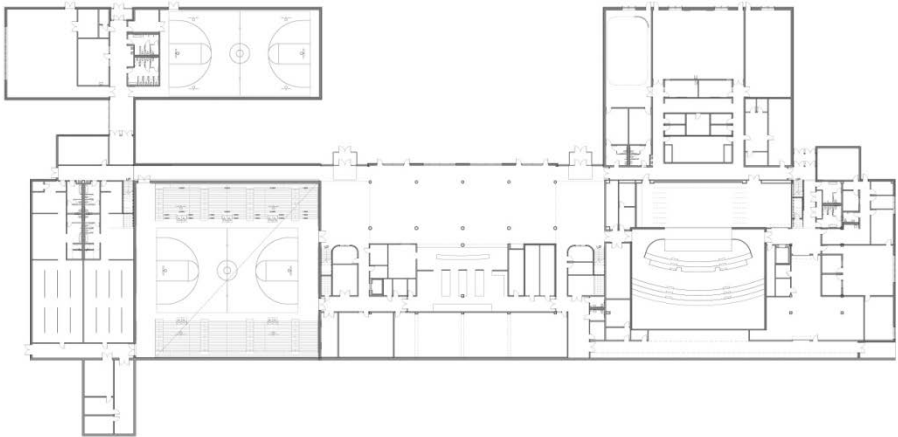

SPED Program 1st Floor

None

NO FORMAL SUBMISSION MADE FOR THE MARCH DD BASELINE ESTIMATE SET



MSBA SCHEMATIC DESIGN SUBMISSION

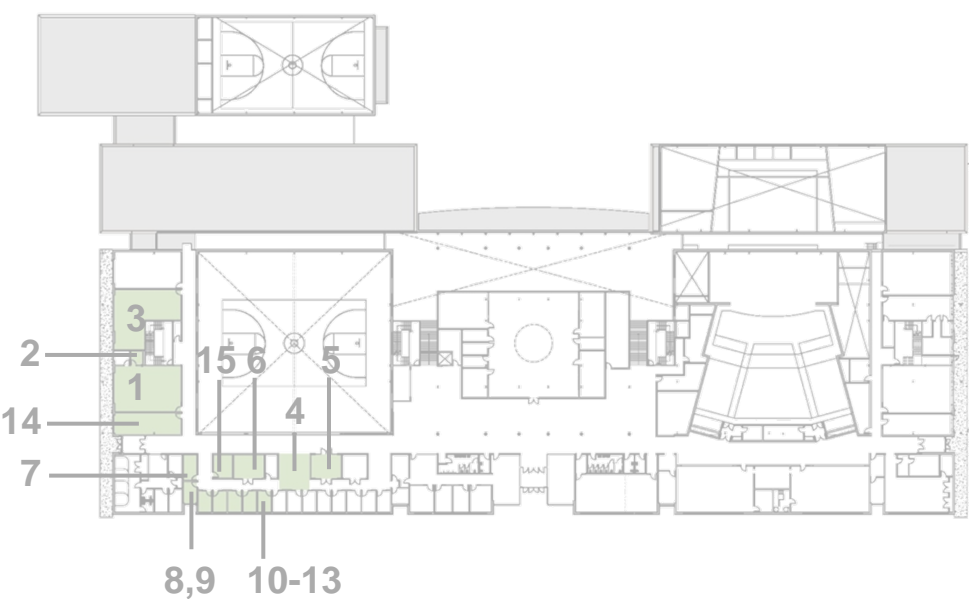

SPED Program 2nd Floor

1. OT/PT	1079 n.s.f.
2. SPED Toilet Room	56 n.s.f.
3. SPED Pathways	1030 n.s.f.
4. SPED Secretary/Waiting	350 n.s.f.
5. Small Group Conf.	258 n.s.f.
6. Small Group Conf.	256 n.s.f.
7. SPED Kitchenette	152 n.s.f.
8. SPED Psychologist Off.	100 n.s.f.
9. SPED Psychologist Off.	100 n.s.f.
10. SPED Offices	99 n.s.f.
11. SPED Offices	99 n.s.f.
12. SPED Offices	99 n.s.f.
13. SPED Offices	99 n.s.f.
14. SPED Resource	503 n.s.f.
15. SPED Workroom	161 n.s.f.

JANUARY 2012 DESE APPROVED SUBMISSION

* The PFA was amended with the DESE approved submission

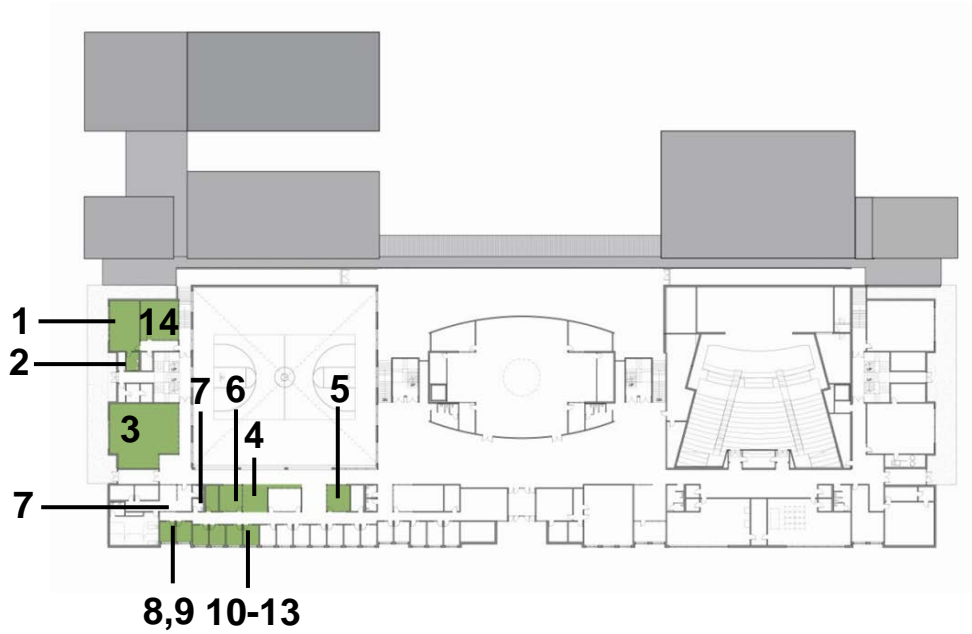

SPED Program 2nd Floor

1. OT/PT	530 n.s.f.
2. SPED Toilet Room	85 n.s.f.
3. SPED Pathways	1400 n.s.f.
4. SPED Secretary/Waiting	275 n.s.f.
5. Small Group Conf.	210 n.s.f.
6. Small Group Conf.	210 n.s.f.
7. SPED Kitchenette	115 n.s.f.
8. SPED Psychologist Off.	105 n.s.f.
9. SPED Psychologist Off.	105 n.s.f.
10. SPED Offices	105 n.s.f.
11. SPED Offices	105 n.s.f.
12. SPED Offices	105 n.s.f.
13. SPED Offices	105 n.s.f.
14. SPED Lighthouse	525 n.s.f.

JUNE DD ESTIMATE



SPED Program 2nd Floor

1. OT/PT*	540 n.s.f.
2. SPED Toilet Room	80 n.s.f.
3. SPED Pathways	1410 n.s.f.
4. SPED Secretary/Waiting	275 n.s.f.
5. Small Group Conf.	210 n.s.f.
6. Small Group Conf.	211 n.s.f.
7. SPED Kitchenette	120 n.s.f.
8. SPED Psychologist Off.	105 n.s.f.
9. SPED Psychologist Off.	105 n.s.f.
10. SPED Offices	105 n.s.f.
11. SPED Offices	105 n.s.f.
12. SPED Offices	105 n.s.f.
13. SPED Offices	105 n.s.f.
14. SPED Lighthouse *	539 n.s.f.

* OT/PT and Lighthouse moved closer to Nurse at request of District SPED. Will confirm with DESE.

NO FORMAL SUBMISSION MADE FOR THE MARCH DD BASELINE ESTIMATE SET



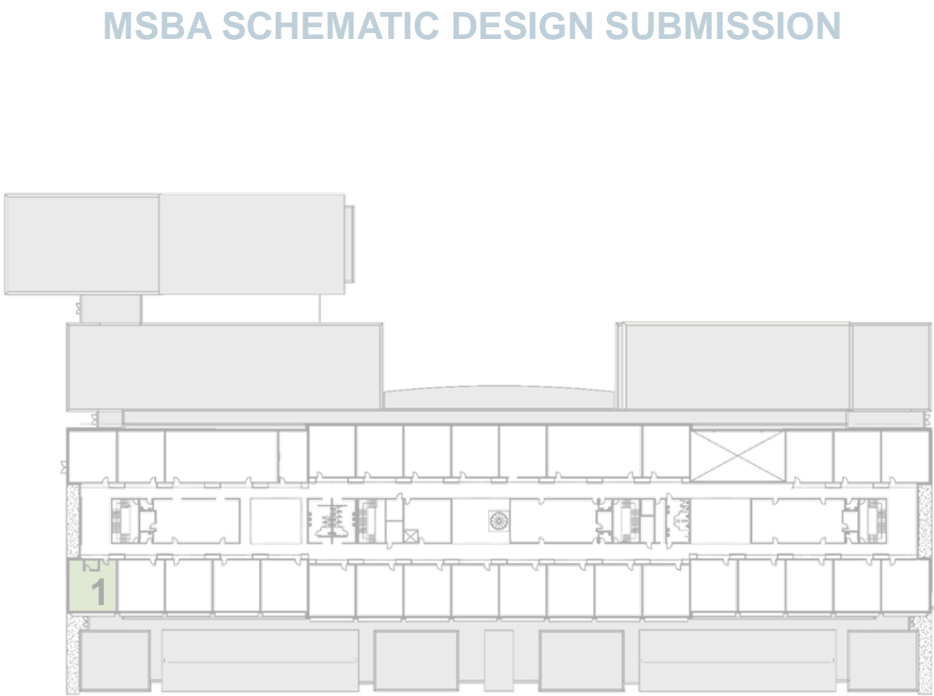

SPED Program 3rd Floor

- | | |
|--------------------|------------|
| 1. SPED Lighthouse | 844 n.s.f. |
|--------------------|------------|

Note: The shared Learning Centers (shared between Core Academic and SPED) were located in the Core Academic Table and were not highlighted as SPED space.

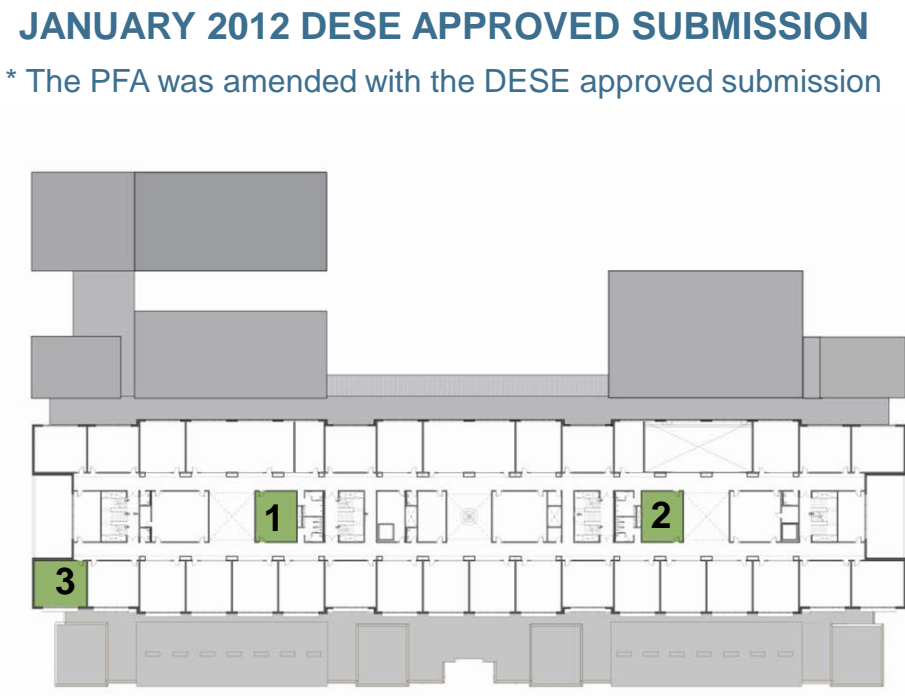

SPED Program 3rd Floor

- | | |
|-----------------------|------------|
| 1. Learning Center * | 725 n.s.f. |
| 2. Learning Center * | 725 n.s.f. |
| 3. SPED Resource Room | 825 n.s.f. |

Note: *Per DESE, the shared Learning Centers (shared between Core Academic and SPED) are now highlighted as SPED, but are still shown in the core academic table, until further discussion with MSBA.

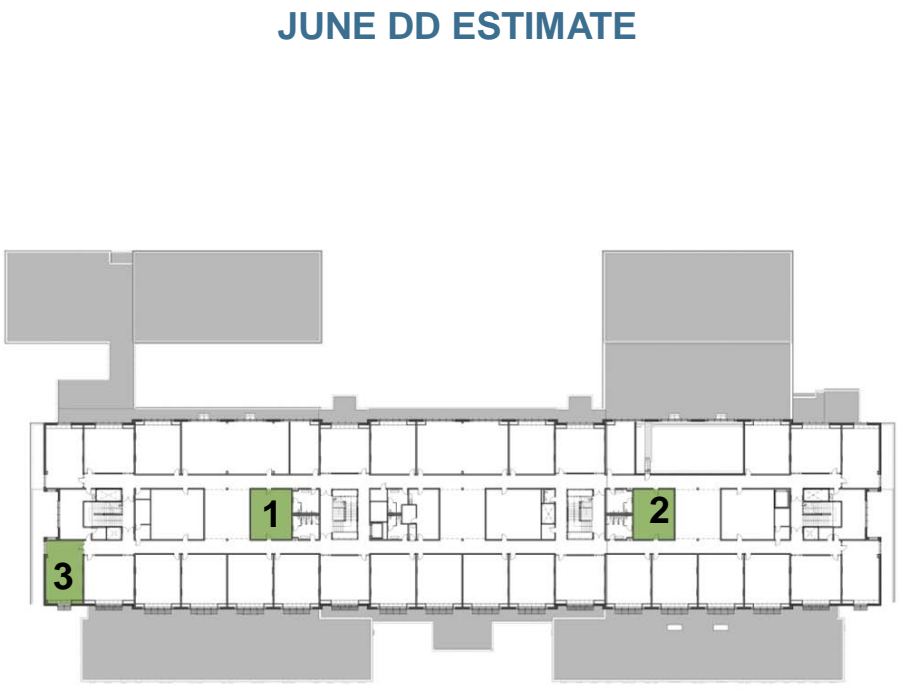

SPED Program 3rd Floor

- | | |
|-----------------------|------------|
| 1. Learning Center * | 715 n.s.f. |
| 2. Learning Center * | 716 n.s.f. |
| 3. SPED Resource Room | 823 n.s.f. |

Note: *Per DESE, the shared Learning Centers (shared between Core Academic and SPED) are now highlighted as SPED, but are still shown in the core academic table, until further discussion with MSBA.

NO FORMAL SUBMISSION MADE FOR THE MARCH DD BASELINE ESTIMATE SET



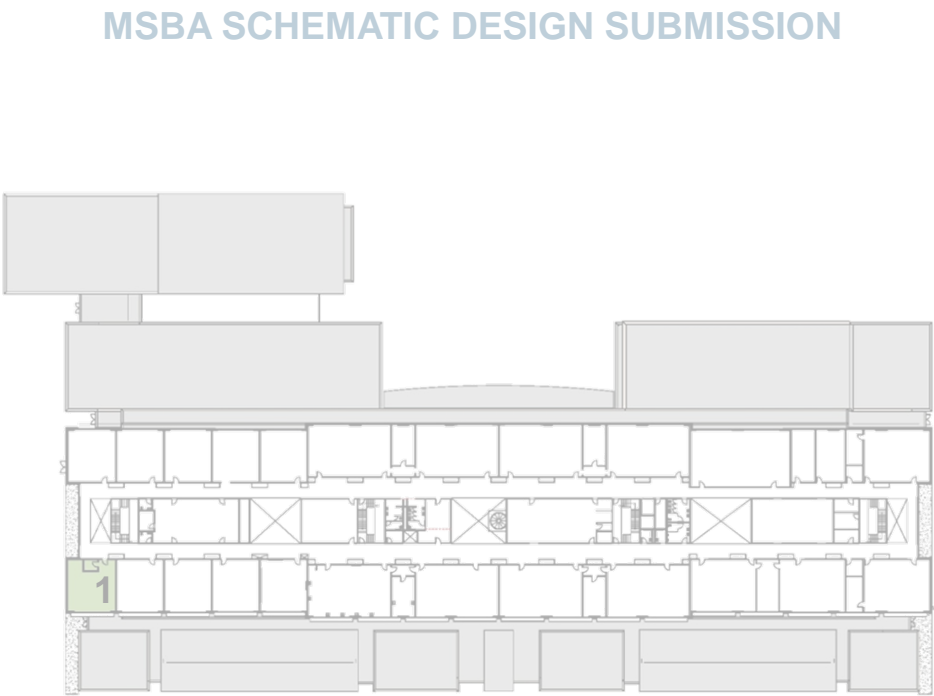

SPED Program 4th Floor

1. Alternate Program	844 n.s.f.
----------------------	------------

Note: The shared Learning Centers (shared between Core Academic and SPED) were located in the Core Academic Table and were not highlighted as SPED space.

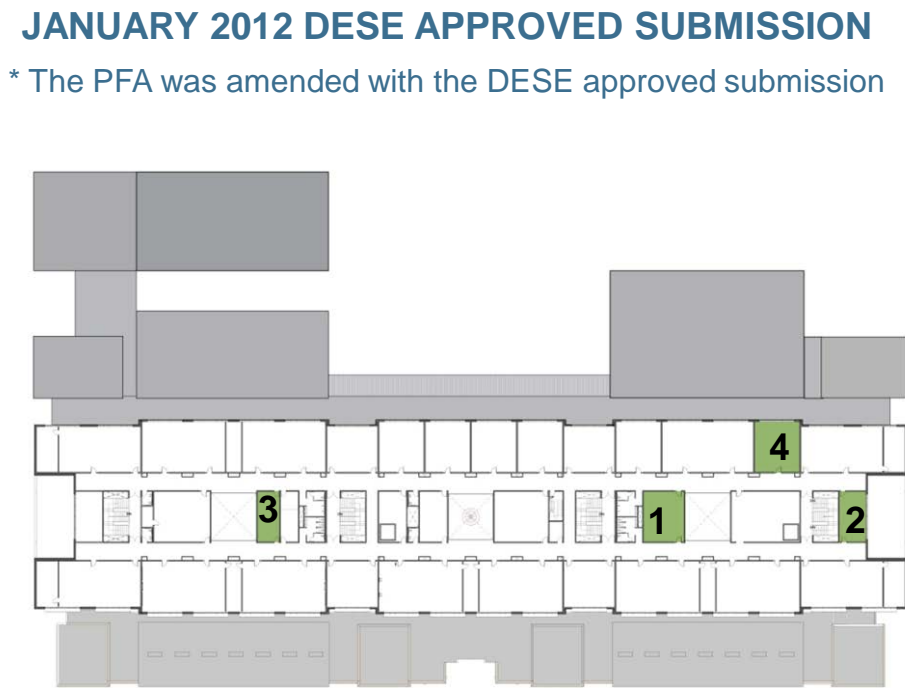

SPED Program 4th Floor

1. Learning Center *	725 n.s.f.
2. Learning Center *	475 n.s.f.
3. Learning Center *	390 n.s.f.
4. Alternate Program	825 n.s.f.

Note: *Per DESE, the shared Learning Centers (shared between Core Academic and SPED) are now highlighted as SPED, but are still shown in the core academic table, until further discussion with MSBA.

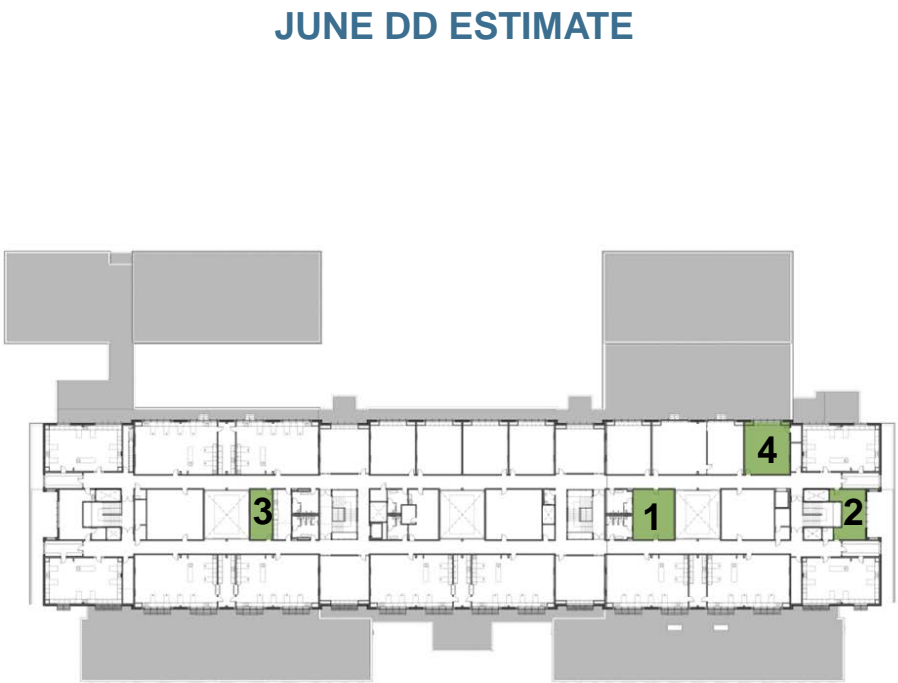

SPED Program 4th Floor

1. Learning Center *	717 n.s.f.
2. Learning Center *	497 n.s.f.
3. Learning Center *	385 n.s.f.
4. Alternate Program	825 n.s.f.

Note: *Per DESE, the shared Learning Centers (shared between Core Academic and SPED) are now highlighted as SPED, but are still shown in the core academic table, until further discussion with MSBA.

NO FORMAL SUBMISSION MADE FOR THE MARCH DD BASELINE ESTIMATE SET

